

MHL

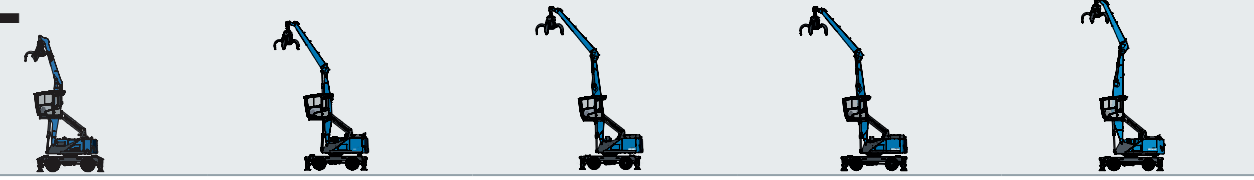

	MHL310	MHL320 MODULAR	MHL331	MHL335	MHL340
	85 kW	95 kW	115 kW	115 kW	129 kW
		95 kW	115 kW	115 kW	128 kW
	75 kW	75 kW	90 kW	90 kW	110 kW
	17,1 t	21,0 t	24,2 t	25,5 t	30,6 t
	9,0 m	10,4 m	12,0 m	12,0 m	13,7 m

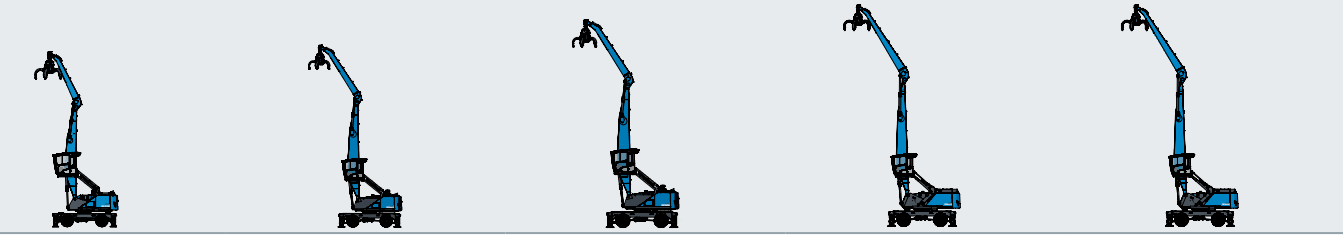

	MHL345	MHL350	MHL355	MHL360	MHL365
	129 kW	160 kW	160 kW	190 kW	190 kW
	128 kW	148 kW	148 kW	186 kW	186 kW
	110 kW	132 kW	132 kW	160 kW	160 kW
	31,2 t	35,5 t	40,9 t	48,8 t	51,8 t
	13,7 m	16,0 m	16,0 m	18,0 m	18,0 m



	MHL370	MHL375	MHL380	MHL390
	230 kW	245 kW	245 kW	300 kW
	230 kW	245 kW	245 kW	273 kW
	200 kW	220 kW	220 kW	250 kW
	52,0 t	66,5 t	71,8 t	87,0 t
	18,0 m	20,0 m	22,0 m	24,5 m



	MHL360 PYLON (0,8 m)	MHL365 PYLON (1,4 m)
	190 kW	190 kW
	186 kW	186 kW
	160 kW	160 kW
	50,1 t	55,5 t
	18,0 m	18,0 m

PYLON-MOUNTED MACHINES
As an option every Fuchs machine can be equipped with a pylon.

MASCHINEN MIT PYLON
Optional kann jede Fuchs Maschine mit einem Pylon ausgestattet werden.

MHL



	MHL420	MHL434	MHL354	MHL364	MHL450
	95/97 kW	115 kW	160 kW	190 kW	180 kW
	95 kW	115 kW	148 kW	186 kW	182 kW
	22,2 t	25,7 t	34,9 t	48,1 t	38,4 t
	12,8 m	10,7 m	11,3 m	12,1 m	16,0 m

RHL

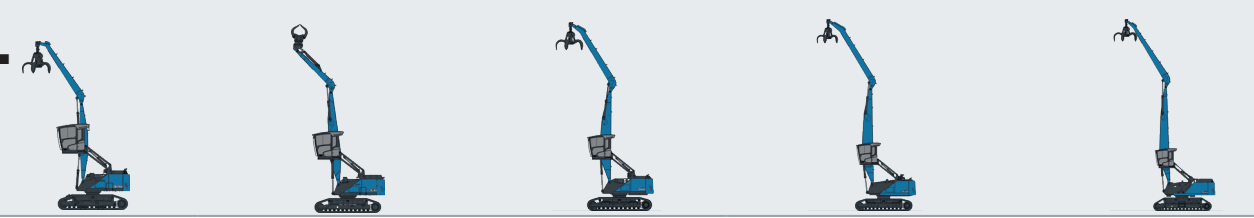

	RHL320	RHL331	RHL340	RHL350	RHL360
	95 kW	115 kW	129 kW	160 kW	190 kW
	95 kW	115 kW	128 kW	148 kW	186 kW
	75 kW	90 kW	110 kW	132 kW	160 kW
	28,5 t	29,0 t	38,0 t	43,0 t	54,0 t
	10,4 m	12,0 m	13,7 m	16,0 m	18,0 m

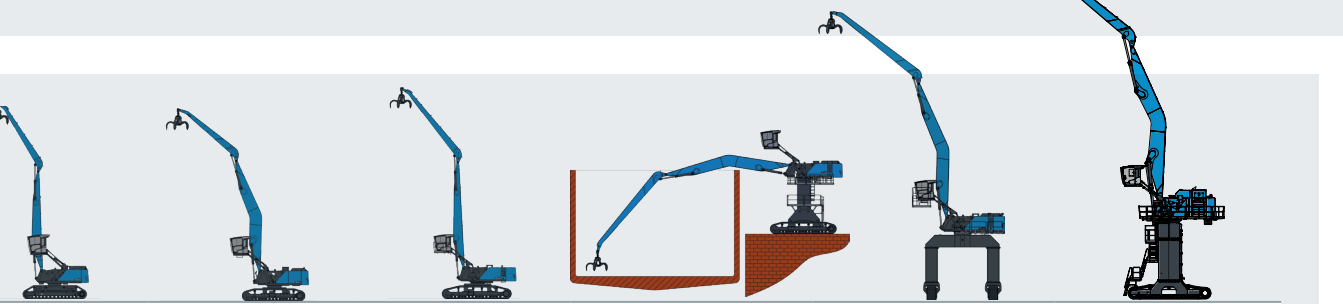

	RHL370	RHL380	RHL390	RHL390 XL	RHL390 GANTRY	F120MH
	230 kW	245 kW	300 kW	300 kW	300 kW	350 kW + 150kW Blue Hybrid System
	230 kW	245 kW	273 kW	273 kW	273 kW	350 kW + 150kW Blue Hybrid System
	200 kW	220 kW	250 kW	250 kW	250 kW	280 kW + 150kW Blue Hybrid System
	55,0 t	77,0 t	96,0 t	105,0 t	110,0 t	150 t
	18,0 m	22,0 m	24,5 m	24,5 m	24,5 m	27 m

FQC

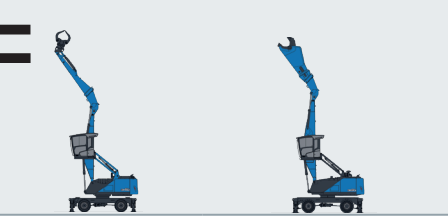

	FQC340*	FQC350*
	129 kW	160 kW
	128 kW	148 kW
	110 kW	132 kW
	29,8 t**	35,5 t**
	11,0 m	13,0 m

* More FQC models upon request / Weitere FQC Modelle auf Anfrage
** Basic machine (with stick head and without attachment)
Grundmaschine (mit Stielkopf und ohne Anbaugerät)

MQC



	MQC345*	MQC350*
	129 kW	160 kW
	128 kW	148 kW
	110 kW	132 kW
	32,0 t	34,4 t
	12,6 m	15,0 m

* More MQC models upon request
Weitere MQC Modelle auf Anfrage

BQC

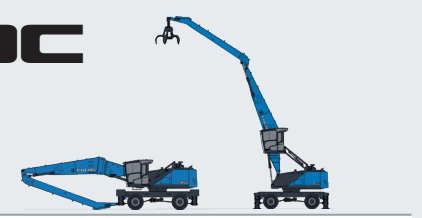

	BQC355*
	160 kW
	148 kW
	132 kW
	40,9 t
	16,0 m

* More BQC models upon request
Weitere BQC Modelle auf Anfrage



Let's handle it!

AHL

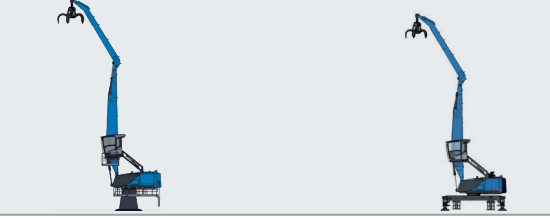

	AHL350 PYLON*	AHL350 STANDARD*
	160 kW	160 kW
	148 kW	148 kW
	132 kW	132 kW
	25,5 t	35,5 t
	16,0 m	16,0 m

* More AHL models upon request
Weitere AHL Modelle auf Anfrage



Key
Legende

- Engine power
EU Stage V / U.S. Tier 4
Motorleistung
EU Stufe V / U.S. Tier 4
- Engine power
EU Stage IIIA / U.S. Tier 3
Motorleistung
EU Stufe IIIA / U.S. Tier 3
- Electric motor
Elektromotor
- Max. service weight
without attachments
Max. Dienstgewicht
ohne Anbaugeräte
- Max. reach
Max. Ausladung

MODULAR SYSTEM

ATTACHMENTS ANBAUGERÄTE



Cactus grab
Mehrschalengreifer



Timber grapple
Holzgreifer

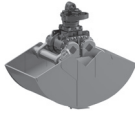

Clamshell grab
Zweischalengreifer



Sorting grapple
Sortiergreifer



Magnet plate
Magnetplatte



Load hook
Lasthaken

WORK EQUIPMENT LADEEINRICHTUNGEN

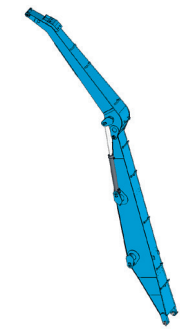

Straight
Gerade

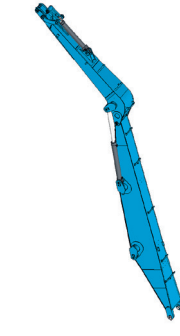

Multipurpose stick
Mehrzweckstiel

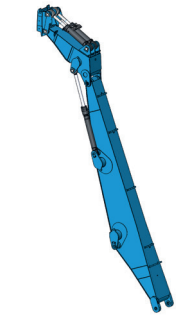

MOC
Multi QuickConnect

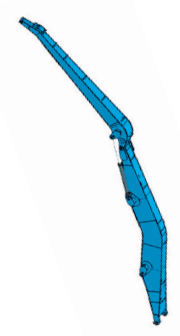

Banana boom
Gekrüppter Ausleger



FOC
Fuchs QuickConnect



BQC
Boom QuickConnect

CAB SYSTEMS KABINENSYSTEME

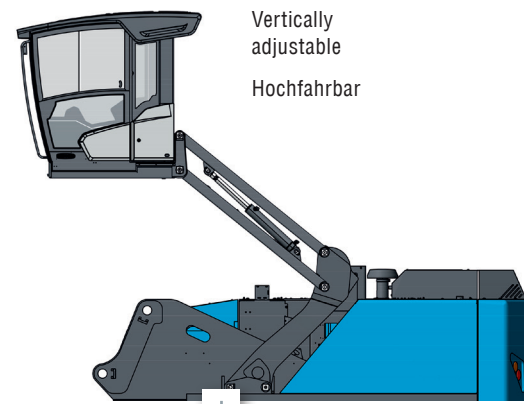

Vertically
adjustable
Hochfahrbar

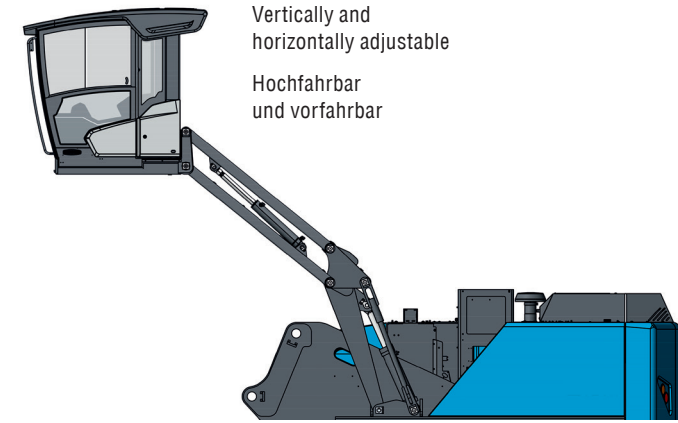

Vertically and
horizontally adjustable
Hochfahrbar
und vorfahrbar

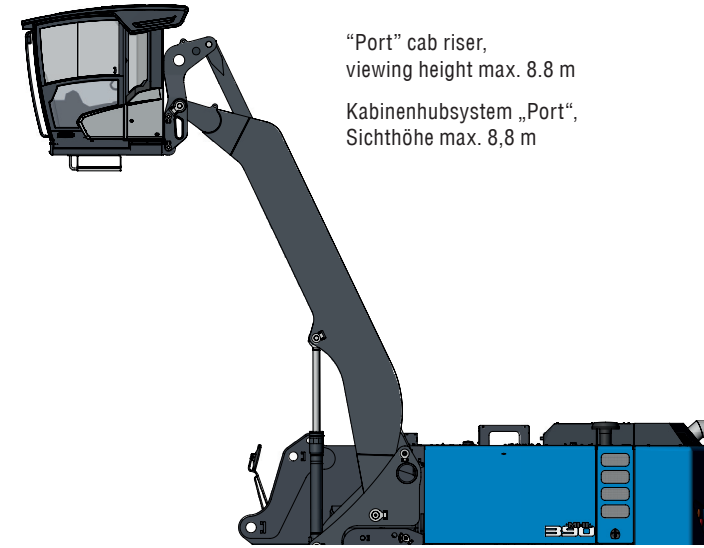

"Port" cab riser,
viewing height max. 8.8 m
Kabinenhubsystem „Port“,
Sichthöhe max. 8,8 m

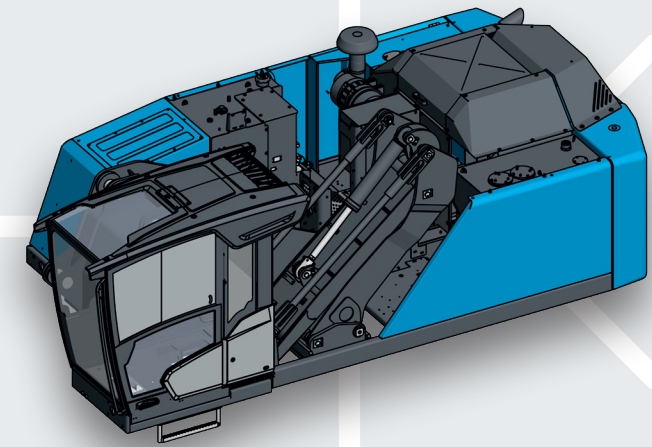

ENGINES | MOTOREN

Diesel engine
Dieselmotor

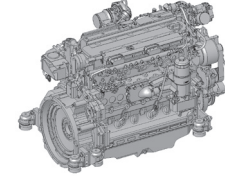

Electric motor
Elektromotor

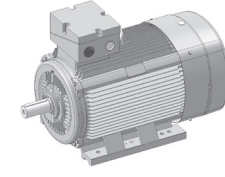

OPTIONS | OPTIONEN

Cable reel
Kabelrolle

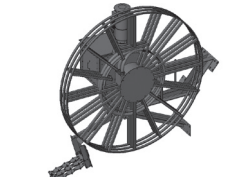

Cable drum
Kabeltrommel

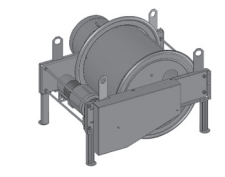

UNDERCARRIAGES UNTERWAGEN

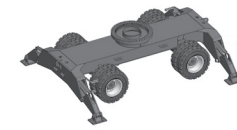

Standard-undercarriage
Standard-Unterwagen

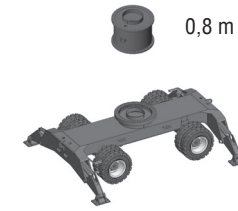

Standard-undercarriage
Standard-Unterwagen

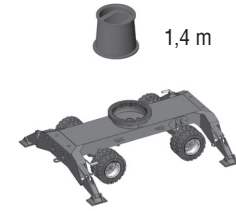

XL-undercarriage
XL-Unterwagen

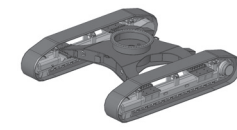

Crawler
Raupe



Crawler
Raupe



Crawler: XL-undercarriage
Raupe: XL-Unterwagen

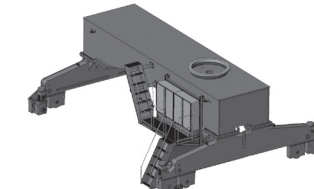

Rail undercarriage
Schienenunterwagen

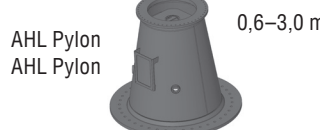

AHL Pylon
AHL Pylon 0,6–3,0 m

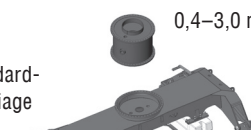

AHL Standard-
undercarriage
AHL Standard-
Unterwagen 0,4–3,0 m

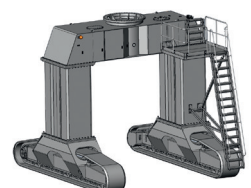

Gantry
Portal



www.terex.com/fuchs

April 2023. Produktbeschreibungen und Preise können jederzeit und ohne Ankündigung geändert werden. Die Fotos und/oder Zeichnungen in diesem Dokument dienen ausschließlich zu Illustrationszwecken. Informationen über den korrekten Einsatz entnehmen Sie bitte dem jeweiligen Bedienerhandbuch für das entsprechende Produkt. Die Nichtbeachtung der Hinweise im Bedienerhandbuch bei der Verwendung unserer Ausrüstung oder andere fahrlässige Verhaltensweisen können zu schweren Verletzungen oder zum Tod führen. Die einzige für unsere Ausrüstung geltende Garantie ist die schriftliche Standardgarantie für das jeweilige Produkt und den entsprechenden Kaufvertrag. Terex gewährt keine weiteren ausdrücklichen oder impliziten Garantien. © Terex Corporation 2023. Terex, das Terex Crown-Logo, Fuchs und Works For You sind Handelsmarken der Terex Corporation oder ihrer Tochtergesellschaften.

April 2023. Product specifications and prices are subject to change without notice or obligation. The photographs and/or drawings in this document are for illustrative purposes only. Refer to the appropriate Operator's Manual for instructions on the proper use of this equipment. Failure to follow the appropriate Operator's Manual when using our equipment or to otherwise act irresponsibly may result in serious injury or death. The only warranty applicable to our equipment is the standard written warranty applicable to the particular product and sale and Terex makes no other warranty, express or implied. © Terex Corporation 2023. Terex, the Terex Crown design, Fuchs and Works For You are trademarks of Terex Corporation or its subsidiaries.

Terex® Deutschland GmbH | Industriestraße 3 | 76669 Bad Schönborn | Germany | Fon: +49 (0) 7253 84-0 | Fax: +49 (0) 7253 84-102 | info@terex-fuchs.com



DE | EN

Produktprogramm | Product Portfolio

FUCHS MATERIAL HANDLERS

